

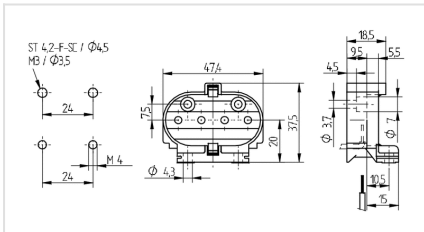

# 26.726.4803

Compact Fluorescent Lampholders  
2G11



<b>Color:</b>	weiß
<b>FC:</b>	50
<b>Part no.:</b>	26.726.4803.50



0,5 - 1,0 mm<sup>2</sup>

U out  
500 V

T 140



## Description

- Screw mount horizontally holes: ø 4.3 mm for screws ISO 1207 - M4
- Screw mount vertically holes: ø 3.7 mm for screws ISO 1207 - M3 or for self-tapping screws with locating groove ISO 1481 - ST 4.2 - F/ ISO 4753 - SC
- For cable insertion direction please refer to drawing
- Instantstart version for USA and Canada: with integrated short circuiting bridge

<b>Short description:</b>	For lamps TC-L
<b>Product name:</b>	Lampholder 2G11
<b>LED type:</b>	2G11
<b>Farbe:</b>	white
<b>Mounting method 1:</b>	Vertical screw mount
<b>Mounting method 2:</b>	Screw mounting horizontally
<b>Material:</b>	Housing: PBT
<b>cULus file no.:</b>	E-92235
<b>Weight:</b>	14
<b>Approval:</b>	additional cULus
<b>Pkg.:</b>	250